

# Double pocket wagon T3000e, Sdggmrss

For the transport of trailers, large containers and swap-bodies



## Advantages

- Loading of all mega trailers incl. Schmitz MEGA and Kögel Euro Trailer and Big-MAXX (14,9 m)
- Loading of 30'-Containers possible (Version 2017)
- Support frame adjustable in 3 heights / Support frame indicator
- Loading aids/load support for heavy and long 40'/45'-Units (Version 2017)
- Useable as 104'-Wagon
- UK-capable (up to Balking Terminal - Version 2017)

## Payload

Load limits

	A	B	C	D	
S	61,0 t	73,0 t	85,0 t	100,0 t	***
SS	61,0 t	73,0 t	85,0 t		

Wagon marking

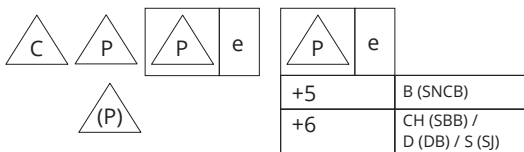

Tare weight	35'000 kg
Max. brake weight	108 t
Handbrake weight	20 t

## Dimensions

Length over buffers	34'200 mm
Loading length	2 x 16'185 mm
Distance between bogie centers	2 x 14'200 mm
Axles base in bogie	1'800 mm
Height of loading stack over rail	270 mm
Height of loading platform over rail	1'155 mm
Length of loading pocket	10'490 mm
Saddle height for trailer	880 mm, 980 mm, 1'130 mm
Track gauge	1'435 mm



## Technical data

Bogie	2 x Y25 Ls(s)i1 1 x Y25 Ls(s)i1(f) with handbrake
Axle load	22,5 t
Brake	DAKO DK-GP-A
Brake blocks	Jurid 816 M BG (320 mm)
Buffers	UIC 526-3, classe L
Drawing gear	Strengthened 1500 kN (Version 2017)

## Operation

Area of use	TEN G1, GE
Transport of trailers	The trailers are only fastened with their kingpin secured in the support frame and locked. Wheel chocks in the loading pocket are no longer provided. 2 x trailers with a total weight of 40 t each can be loaded.
Spigots	For the transportation of total of 4 freight containers of class C (up to 7,82 m) and 2 freight containers of class A (13,6 m and longer with medium support) are provided 2 x 10 spigots are provided according to UIC regulations. The design and arrangement of the bolts is suitable for 2,60 m wide containers. The new version of the T3000e provides for the transport of these additional main cases: 2 containers 30' up to max. load of 2 x 36 t 2 class A swap bodies 4 x ISO up to max. load 36 t + 34 t (or 2 x 35 t) with medium support.
Smallest navigable track curve	
Single car	75 m
Trainset	150 m
Max. ferryboat capacity	1°30'

## Double pocket T3000e

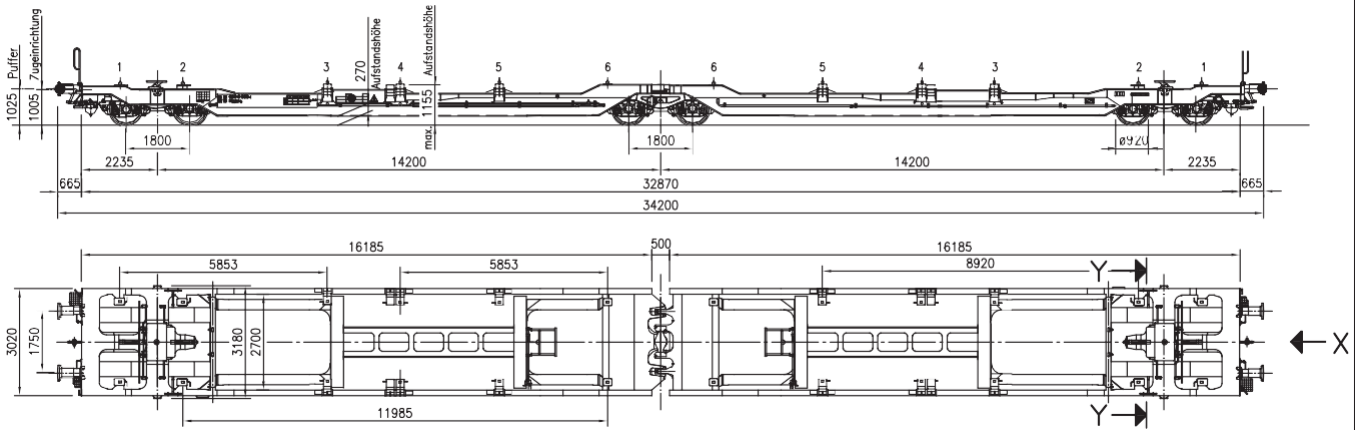

## Loading plan

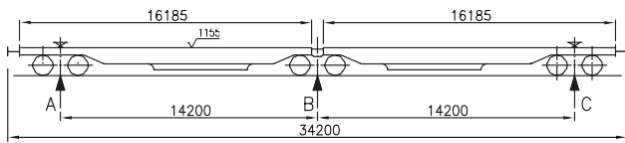

Loading plan trailer (11t+27t)		
Ser. Nr.	Wheelbase R [mm]	Weight [t]
1	7300	40
2	7500	40
3	7700	40
4	7900	40
5	8100	40

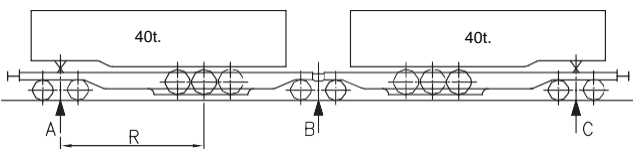

Loadin plan CT								
Ser. Nr.	CT1		CT2		CT3		CT4	
	CT-Typ	Weight [t]	CT-Typ	Weight [t]	CT-Typ	Weight [t]	CT-Typ	Weight [t]
6	20-24	36,0	20-24	0,0	20-24	0,0	20-24	36,0
7	20-24	36,0	20-24	6,0	20-24	6,0	20-24	36,0
8	20-24	34,0	20-24	11,0	20-24	11,0	20-24	34,0
9	20-24	32,0	20-24	17,0	20-24	17,0	20-24	32,0
10	20-24	30,0	20-24	18,0	20-24	18,0	20-24	30,0
11	20-24	28,0	20-24	19,0	20-24	19,0	20-24	28,0
12	20-24	20,0	20-24	20,0	20-24	20,0	20-24	20,0
13	20-24	16,0	20-24	21,0	20-24	21,0	20-24	16,0
14	20-24	10,0	20-24	22,0	20-24	22,0	20-24	10,0
15	20-24	0,0	20-24	23,5	20-24	23,5	20-24	0,0

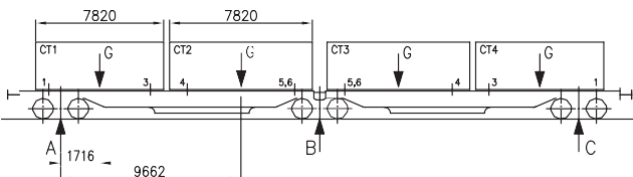

Loading plan CT				
Ser. Nr.	CT1		CT2	
	CT-Typ	Weight [t]	CT-Typ	Weight [t]
16	40-45	35	40-45	35
17	40-45	36	40-45	34

Loading plan CT				
Ser. Nr.	CT1		CT2	
	CT-Typ	Weight [t]	CT-Typ	Weight [t]
18	30-31	36	30-31	36

- Note: Wagons may not be loaded with semi-trailers if the support frame deadline has expired!